

Serena

by  LUTRON

See how easy it is to:

- Measure for Serena shades
- Choose and program controls
- Install shades
- Change batteries
- Integrate with other systems

For more information and step-by-step videos, please visit serenashades.com



Lutron Electronics Co., Inc.
7200 Suter Road
Coopersburg, PA 18036-1299

Customer Service 1.855.573.7362
Contact a Serena Shade Specialist 7 days a week
8 a.m.–8 p.m. Eastern, Mon–Fri
9 a.m.–9 p.m. Eastern, Sat–Sun
World Headquarters 1.610.282.3800
Technical Support 1.800.523.9466 — Available 24/7

Apple is a trademark of Apple Inc., registered in the U.S. and other countries. HomeKit is a trademark of Apple Inc.

Google is a registered trademark of Google Inc.

Lutron, the Lutron logo, Caséta, Claro, Pico, and Serena are trademarks of Lutron Electronics Co., Inc., registered in the U.S. and other countries.

© 04/2023 Lutron Electronics Co., Inc. | P/N 367-2447 REV G



Create Your Comfort
Zone with Smart Shades



Synchronized.
Silent. Smart.



Maximum comfort and convenience

What if you could schedule your window shades to automatically raise at a set time every morning, so you could wake up to a soft light? Or close your shades before you get into your tub, and then open them with the press of a button to enjoy the view?

What if you could integrate your shades with other smart home solutions to create a one-of-a-kind experience?

With Serena automated shades, you can enjoy those conveniences and more!

Our ultra-quiet, battery powered shades install wirelessly. Designed with your lifestyle in mind, you can control them from anywhere in the room via remote or anywhere in the world with the free Lutron App.



Why Serena?



Easy to install

Shades install and operate without wires. You can mount them inside or outside the window frame.

Low maintenance

Shades feature industry-leading battery performance, and you can replace the batteries without taking down the shade.

Cordless design

A safer solution for homes with children or pets.

Three design choices

Available in roller, honeycomb, or wood-blind style with a variety of headrail options.

Fashionable aesthetics

Choose from a wide selection of materials and fabric colors, textures, and light-filtering options.

Smart device control

Use the smart hub and free Lutron App for convenient control from anywhere.

You can also integrate shade control with other smart home solutions, including Amazon Alexa, Apple® HomeKit™, Google® Assistant, and more!

Warranty

Shades are backed by Lutron's 8-year warranty.

24/7 Support

Dedicated Shades Specialist and Technical Support teams based in the U.S.

Roller Shades



Contemporary and stylish, roller shades are available in a wide variety of colors, from neutrals to vibrant bolds. Unique textures such as two-toned weaves, woven fibers, and delicate linens add to your design choices.

- Available as wide as 96" and as tall as 120"
- Uses 6–8 standard, D-cell alkaline batteries, depending on shade size
- Sheer, translucent, and blackout fabric options
- Available with fabric-wrapped or architectural metal fascia, or without fascia
- Innovative headrail simply rotates forward to replace batteries without removing the shade



Architectural Honeycomb Shades



Architectural honeycomb shades feature a 3/4" cell size to provide an updated look to the classic honeycomb style. Available in blackout and light-filtering fabric collections that offer a full range of neutrals, decorative prints, and rich textures.

- Available as wide as 96" and as tall as 104"
- Uses 8 standard, AA lithium or D-cell alkaline batteries, depending on shade size and fabric choice
- Modern headrail design with integrated, top back cover provides a seamless look with precision fit to reduce light creep
- Features our exclusive Tap 'n' Tilt bracket technology for easy battery installation and changes



Standard Honeycomb Shades



Standard honeycomb shades add a signature look to any space. Choose from woven linens and airy sheers, in traditional neutrals as well as bold hues.

- Available as wide as 96" and as tall as 104"
- Uses 4–8 standard, AA lithium or D-cell alkaline batteries, depending on shade size
- Sheer, light-filtering, and room-darkening fabric options
- Features our exclusive Tap 'n' Tilt bracket technology for easy battery installation and changes



Wood Blinds



The timeless, elegant look of wood blinds combined with groundbreaking, smart technology. Available in a variety of stained and painted finishes.

- Natural Light Optimization allows blinds to automatically tilt based on the position of the sun throughout the day (smart hub required)
- Single blinds available as wide as 72" and as tall as 72"; two blinds under one valance are available as wide as 96" and as tall as 72"
- Uses 4–12 standard, AA lithium or D-cell alkaline batteries, depending on shade size
- Customized bottom rail to easily lift or lower the blinds manually



Convenient Control



Place a Pico remote control on your nightstand so you can open your shades to let the sun shine in without getting out of bed.

- Remote is easy to program
- Pedestal (sold separately) adds a finished look
- Available in many colors for any aesthetic
- Remote uses Lutron reliable, Clear Connect RF technology, which operates on a quiet frequency band that's free of interference



Pico on pedestal
(sold separately)

Control Where You Want It



Add an additional point of control by mounting a Pico on your wall.

- Mount to any surface
- No cutting holes or wiring required
- Fits in a standard wallplate, including Lutron's screwless Claro wallplate
- Has a 10-year battery life

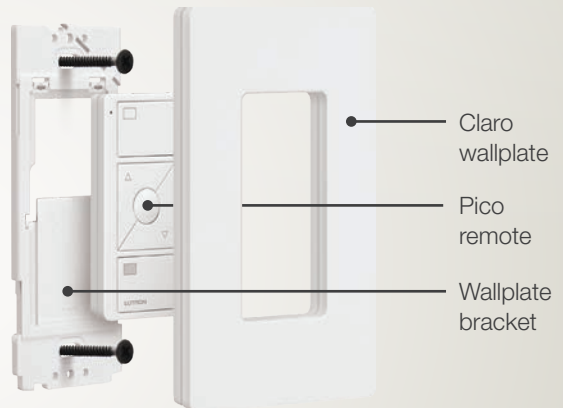

Pico remote wall-mounting kit
(sold separately)

Multi-Group Control



Create the perfect view, or eliminate glare, by controlling different groups of shades with a wireless, 4-group remote.

- Control groups of shades with the touch of a button
- Control one group at a time or all groups at once
- Set and recall preferred shade levels with the Favorite button



Lutron App & Smart Hub



You can easily make Serena shades part of your connected home. All you need is the Lutron smart hub and free Lutron App. With the app, you can monitor and control shades from anywhere with your smart device.

- Simple setup
- Create personalized scenes and schedules
- Add Caséta by Lutron smart lighting control; monitor and control lights as well as shades with your smart device; schedule shades and lights to adjust together, or create personalized lights and shades scenes

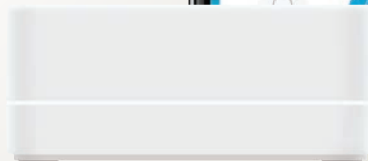

Add Additional Smart Home Products



The Lutron smart hub also works with other leading smart home brands for seamless integration. Expand your system and add even more convenience to your day-to-day routine. Here are just a few examples of what integration can do for you:

- Busy making dinner? Control lights and shades with your voice.
- Setting the mood? Create preset scenes for your shades, lights, and music.

